

Cruise Control

SET/RESUME Switch Test (With SRS Type II)

CAUTION:

- All SRS electrical wiring harnesses are covered with yellow outer insulation.
- Replace the entire affected SRS harness assembly if it has an open circuit or damaged wiring.
- Before disconnecting the SRS wiring harness, turn the ignition switch off, disconnect the negative and positive battery cables, and wait at least three minutes.

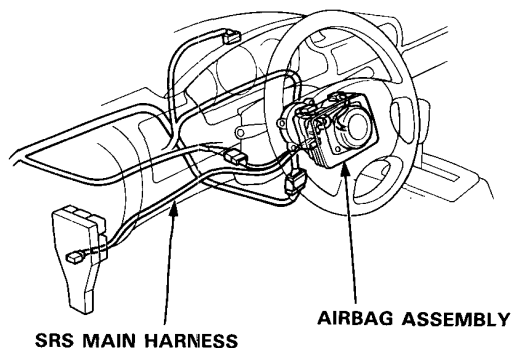

1. Remove the dashboard lower cover and steering column covers.

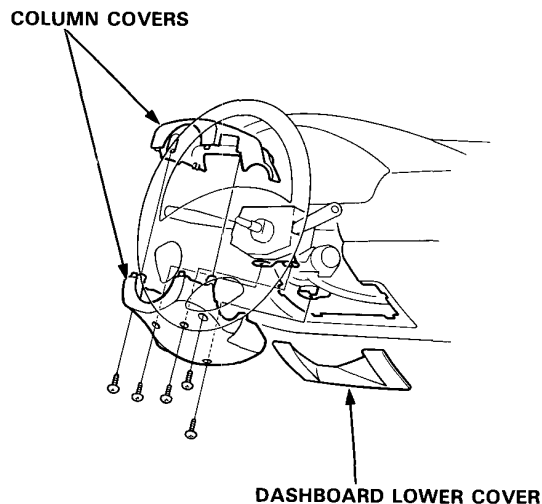

2. Disconnect the SRS main harness 4-P connector from the main wire harness.

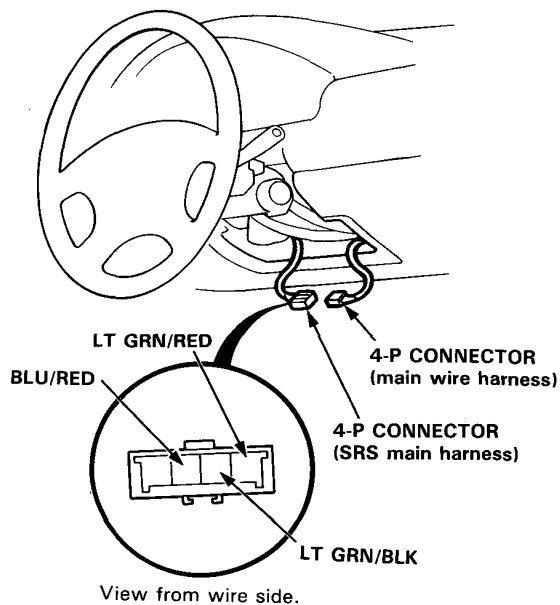

3. Check for continuity between the terminals in each switch position according to the table.

Terminal Position	BLU/RED	LT GRN/RED	LT GRN/BLK
SET(ON)	○	○	
RESUME(ON)	○		○

- If there is continuity, the SET/RESUME switch is OK.
- If there is no continuity, go to step 4.



4. Disconnect the 5-P connector from the slip ring.

NOTE: See page 16-140 before removing the connector for locked with the connector lock pin.

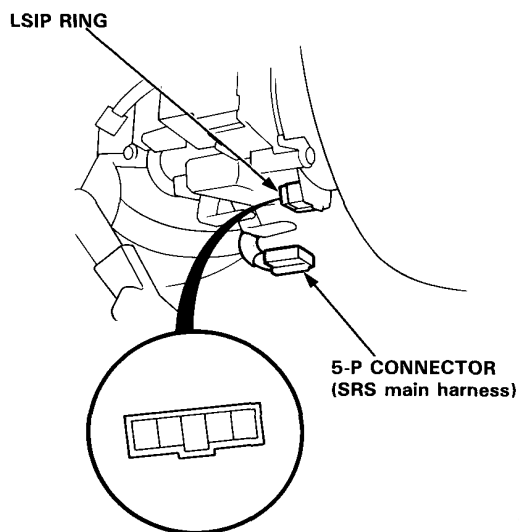

5. Check for continuity between the terminals in each switch position at the slip ring side according to the table.

Terminal Position	1	2	3	4	5
SET(ON)			○	○	
RESUME(ON)			○	○	○

- If there is continuity, an open in the SRS main harness.
- If there is no continuity, go to step 6.

6. Remove the switch cover from the SET/RESUME switch, then separate the SET/RESUME switch by removing the 2 screws.

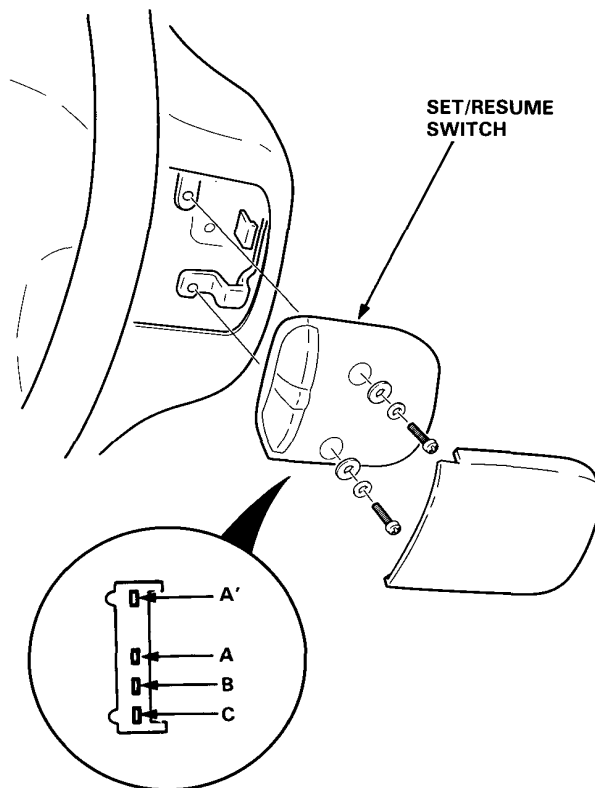

7. Check for continuity between the terminals in each switch position according to the table.

Terminal Position	A or A'	B	C
SET (ON)	○	○	○
RESUME (ON)	○	○	

- If there is continuity, check for:
 - Faulty slip ring (see page 16-96).
 - A bent, loose or corroded terminal, or an open in the SRS sub harness.
- If there is no continuity, replace the switch.